

TYPICAL INSTALLATION DETAILS FOR WOOSTER SAFETY TREADS

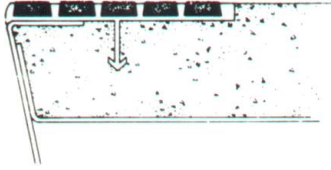

DETAIL
Sure-hold anchor in sloped riser steel pan step.

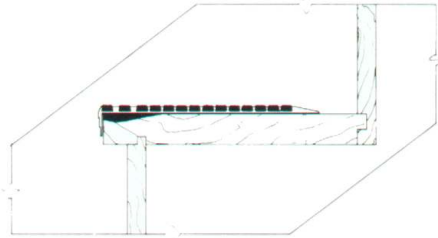

Type 500 Stairmaster superimposed on wood step. If steps are other than wood, use screws with expansion shields and an application of adhesive.

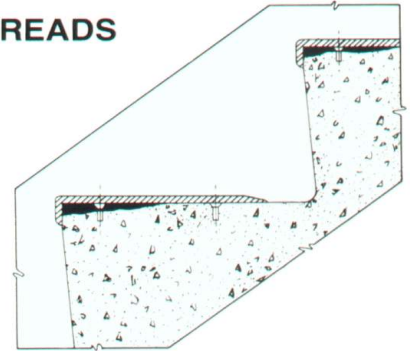

Type 116A superimposed on concrete step which has been leveled. Use wood screws with exp. shields. Use adhesive between treads.

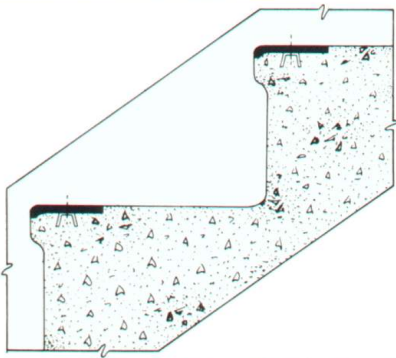

Type 101 with wing type anchors in poured concrete stair.

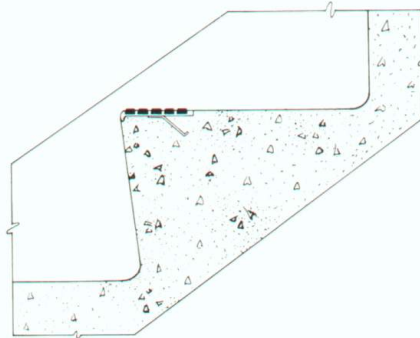

Type 131 with Time-Saver strap anchors in new concrete stair.

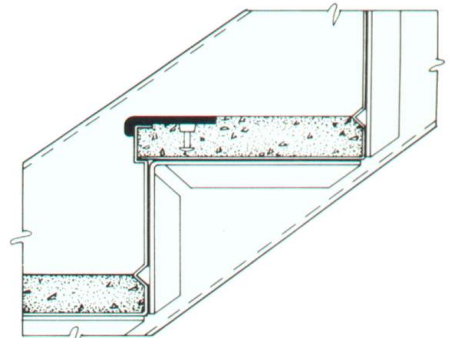

Type 101SP with concealed integral anchor in steel pan stair.

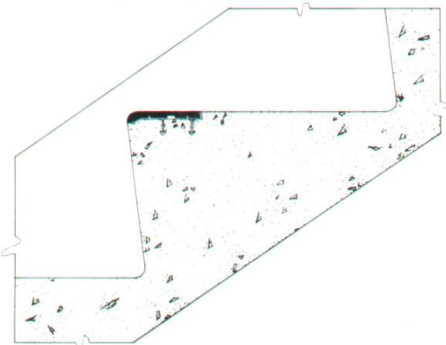

Type WP3C with integral Sure-Hold anchor in new concrete stair.

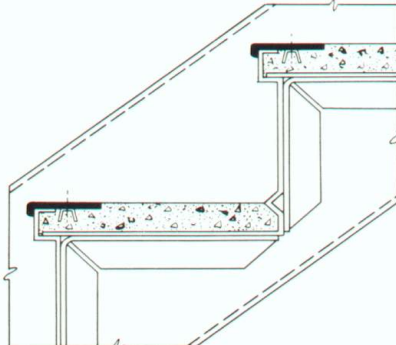

Type 101SP with wing type anchors in concrete filled steel pan stair.

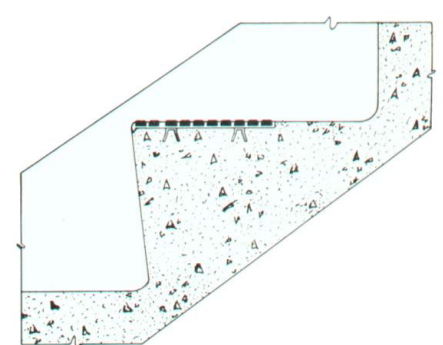

Type 161 SuperGrit with wing-type anchors in poured concrete stair.

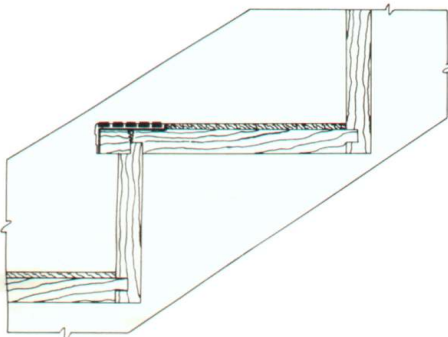

Type 142 SuperGrit attached to wood tread and backed with tile, carpet, or other material.

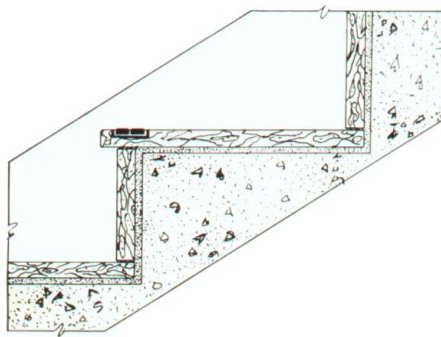

Type 610 SuperGrit rabbeted into marble or terrazzo. Held in place with screws, shields and adhesive.

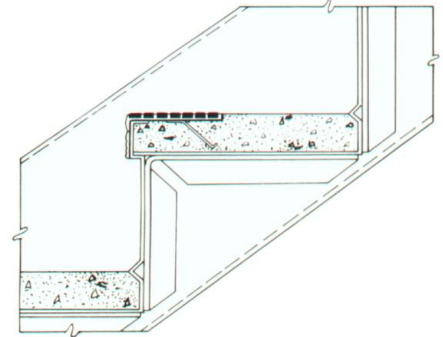

Type 143 SuperGrit with Time-Saver strap anchors in cement filled steel pan.